

YOU WILL NEED

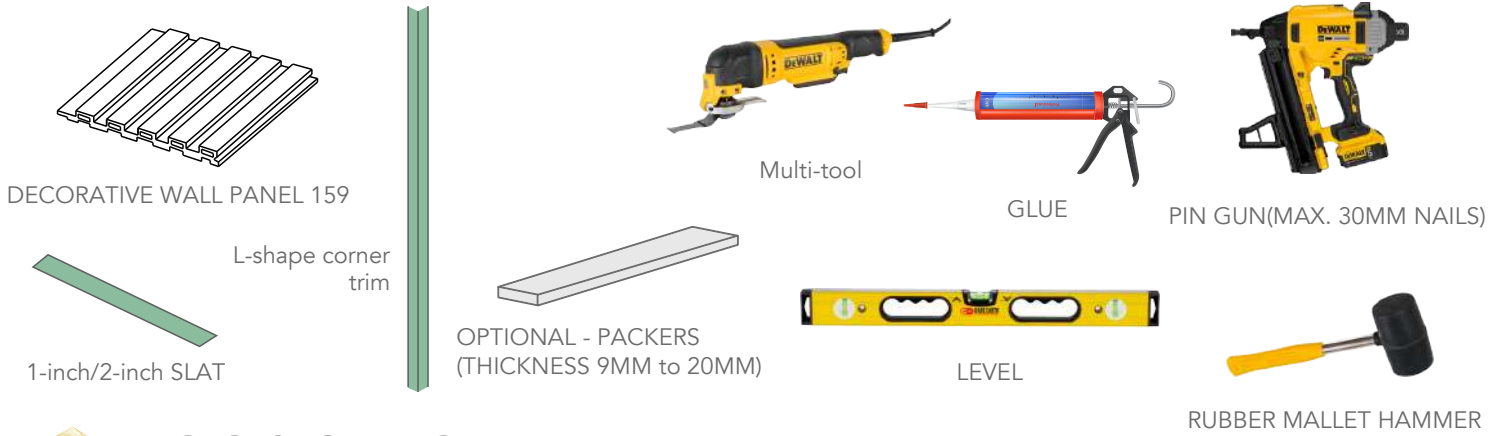

BASIC & STEPS



OPTION 1

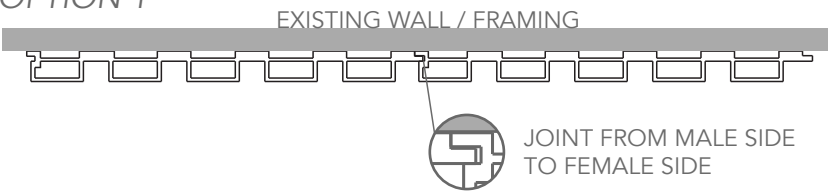

OPTION 2

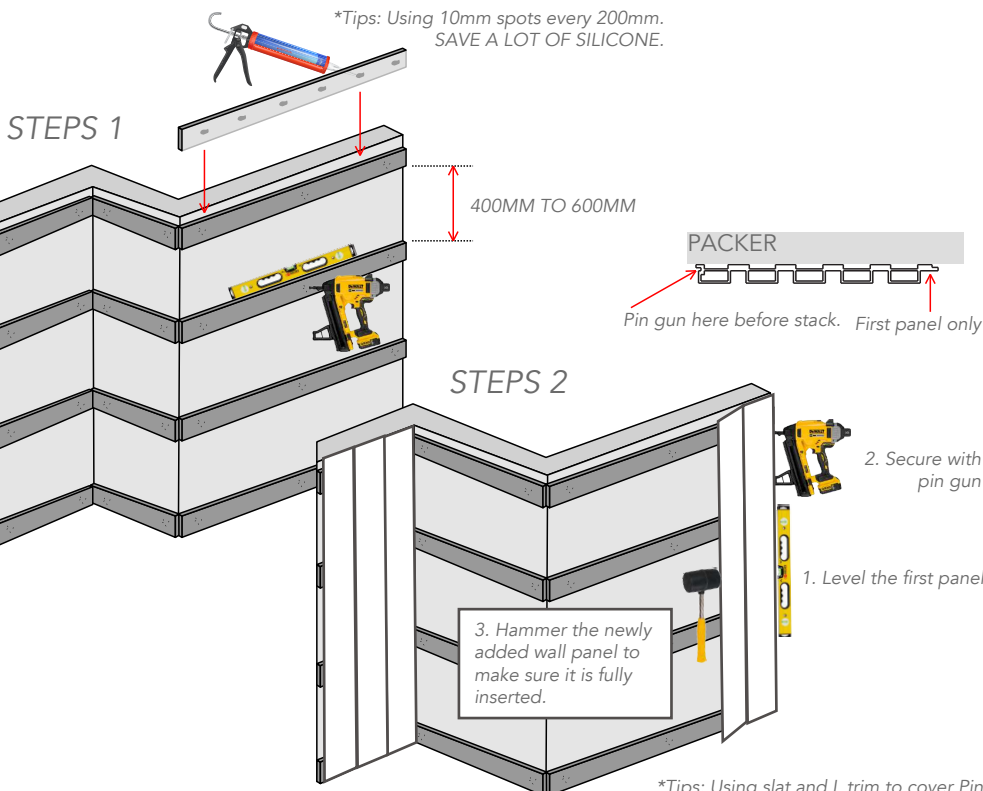
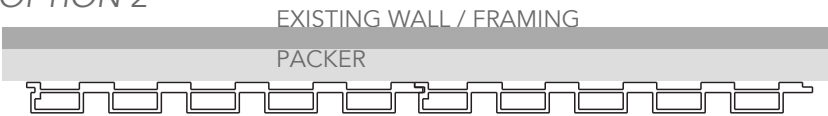

Description

OPTION 1

For direct fixing system make sure surface substrate is true and level.

OPTION 2 (Recommended)

STEP 1

Using packers on surface before placing wall panels. To avoid existing skirtings, non level surfaces, corner not square, and such.

Install packer at a maximum of 600mm centres (Recommended at 400mm centres).

Identify solid fixing points in the existing wall or framing. Level for packer, Then using pin gun and glue to secure each. Taking care to avoid electrical cables & plumbing.

INSTALLING WALL PANELS

STEP 2

Cut wall panel to length. Then layout wall panel from the male side, allow the next panel to joint from the female side.

Using level to make sure the first panel is level. Identify solid fixing points in the existing wall or framing. Then, using pin gun to secure the first panel.



Secure with pin gun at female side before stacking next panel. Hammer the newly added wall panel to make sure it is fully inserted.

YOU WILL NEED

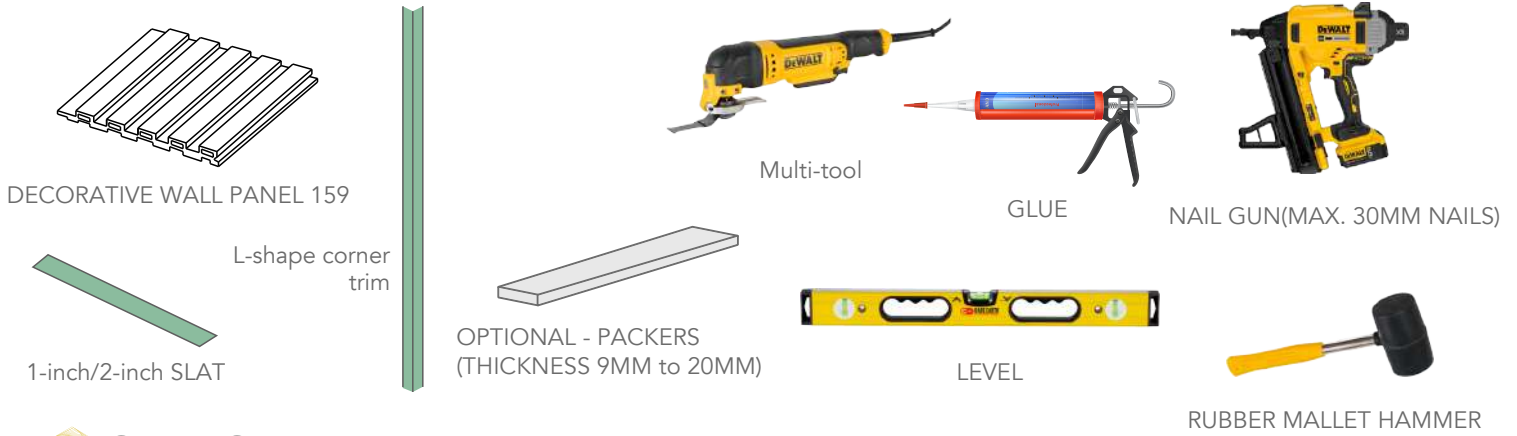

STEPS

STEPS 3

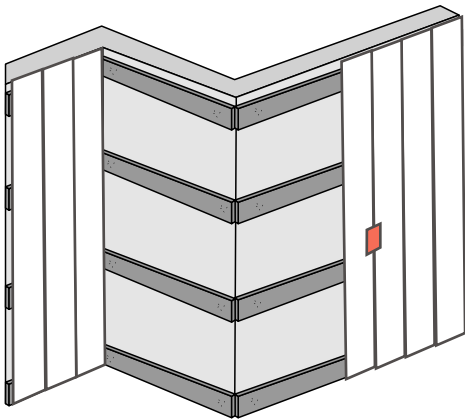

*Tips: Using multi-tool or renovator to cut holes on our wall panel.



*Tips: Do not remove wall panel protection wrap before finish. Draw marks on wall panel where cutting is required.



STEPS 4

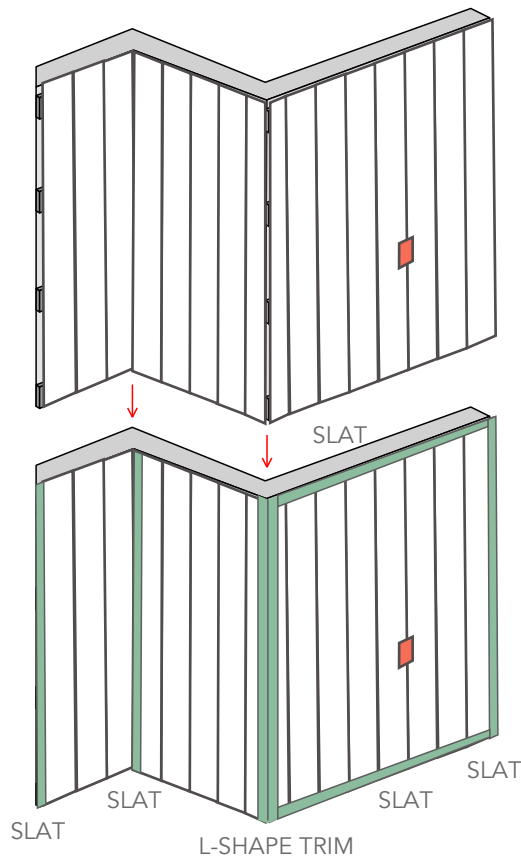

Description

STEP 3

When installing the wall panel you may need to mark out and cut the panels to allow for wall sockets etc.

The sockets can be pulled through the cut hole and reattached on the surface without disconnection.

*Tips: When you are securing the last wall panel, nail gun the edge within the covering slat or L trim width.

STEP 4

Using slat and L-shape trim to cover corners with glue.

Apply covers on all edges. For better finish, join edges using 45 degree angle.

Remove protection wrap and install power points back to position.